

in my project make a contribution to the brasilian discussion about possible tendencies in the region.  
 in the territorial part - i will give a clear proposal to a desirable development.  
 narrowing down - implementing an urban embryo - the project is a strategy in an abstract way / a catalogue of rules to take in consideration while making the physical design.  
 according to the conditions of the specific location .

mono - diversity  
 Startingpoint is the mono - productivity of the region consisting from extraction, siderurgy and export.  
 as a ruling sector the stability is too dependent and should have a balance through diversity within the region.

Diversity: combination, interlinkage, co-existence and simultaneity  
 \* Synergy - interaction  
 \* Including / Excluding certain regions  
 \* Concentration versus homogene - network

what is the project about

my subject deals on a very large territorial scale.  
 we have nearly 1000 km distance between Belo Horizonte and Vitoria.

it has its origin in the actual tendencies in the Region Minas Gerais and Espirito Santo, wich is dominated through the 2 main industries: the iron ore - industry and the cellulose industry.

my goal is give a proposal , how to create sustainability in the region.  
 create new activities to balance the mono-character of the region and to respond to the rapidly changing globalized economics.

the result is not an physical design, but a strategy wich can lead to an intervention. A strategy wich combines 2 contrary scenarios - 2 extreme terms of organizing the territory.

2 uses as a guideline,  
 as dynamic framework  
 the territory is articulates through an Industrial corridor provided by the private companies.

my work try to respond to questions such as:

How to promote or densify regions detached from the productive chain that articulates the territory?  
 How to expand horizontally the productiv arrangements and intensify the capillarity of the infrastructure of transport ?  
 How to provide capillarity in a region where we cannot count on public investement, where we have to use or coordinate the interests of private companies in order to create a desirable social construction for the inhabitants of the region.(win-win) ?

one way to create the win-win between public and private thinking in terms of EFFICIANCY, could be creating small interventions - adjustments provoce / affecting other components. and development.

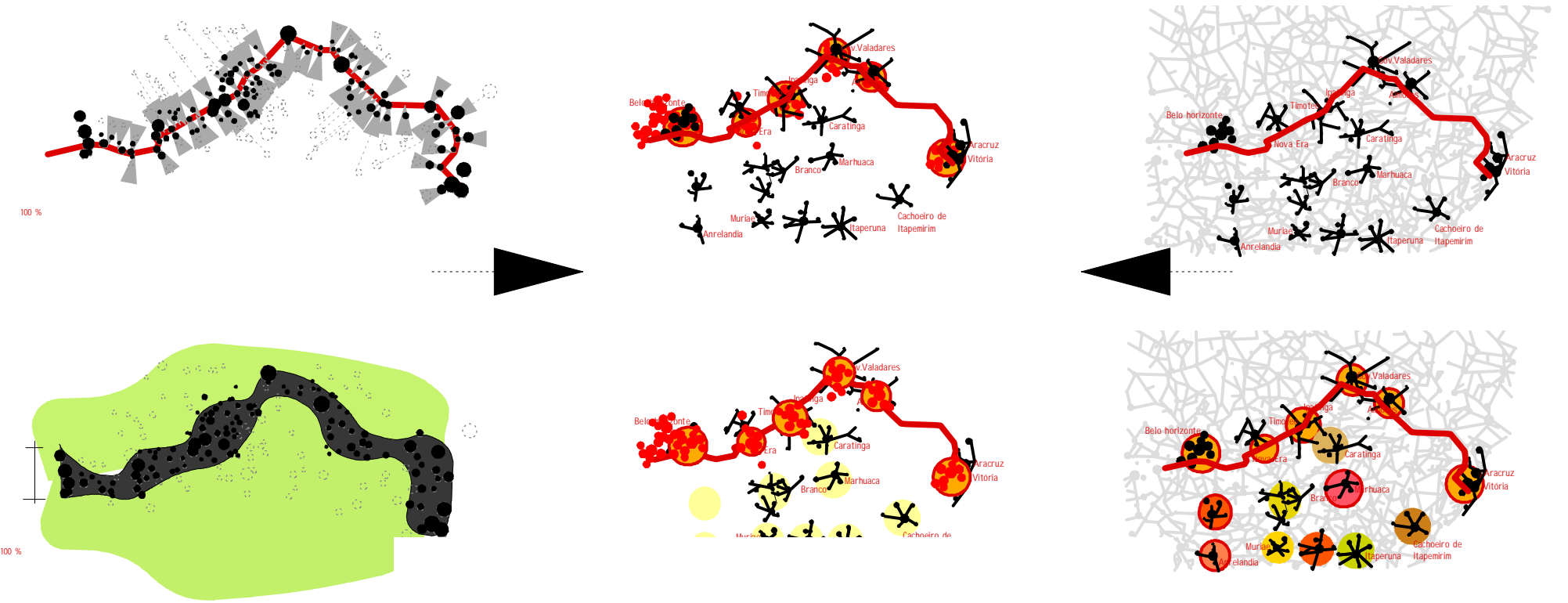

mono industrial szenario

A: enforcement of the industry and the productive chain, leads to migration concentration and growing of the cities  
 the citys can not take the grow,  
 people move out from the cities in surrounding populations, facilities and services will occur  
 -> need 2 create or improve transportsystem between the cities on the chain and the closedby population  
 (appearing related new technologies + educational programm)

B: on the other hand it will lead to de-population of the territory...the young generation might migrate to the belt, the older stay in the territory

what happen with the depopulated territory ?  
 unemployment -> circular effect  
 ->bad image, less immigration of new companies, more unemployment  
 large areas will not be used anymore , deserted cities, ghost cities.  
 services will decline  
 the people who stays will be free from neighbours->

develop into a natural park  
 promoting light tourism-  
 get attractor 4 people from the overgrown cities  
 agriculture?

along the river will be either a recreational area....  
 or can attract new industry...having the same affect of a liniar growing  
 ?...loop-effect

dezentralization szenario

2 create diversity in the region is a multitude of small economic sectors-better , than the big industrial monofunctional zone -  
 -service, financial sector, energy, food, biotech, media...?  
 enforce existing branches

Mosaik of cities - synergie  
 concentrating each municipality on the strongest sector it has  
 and promote new economy-  
 business - living - leisure

encouraging bottom-up economic activities. this can be done in  
 changing the tax-policies. then the number of enterprises would  
 increase

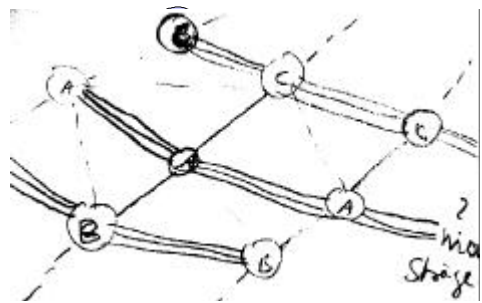

DIVERSITY - connections

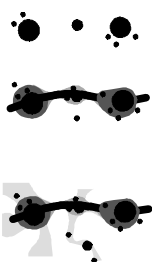
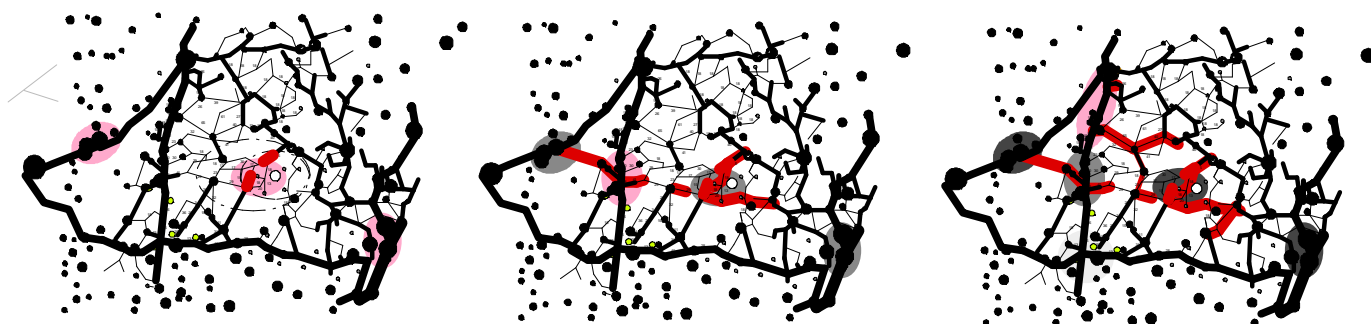
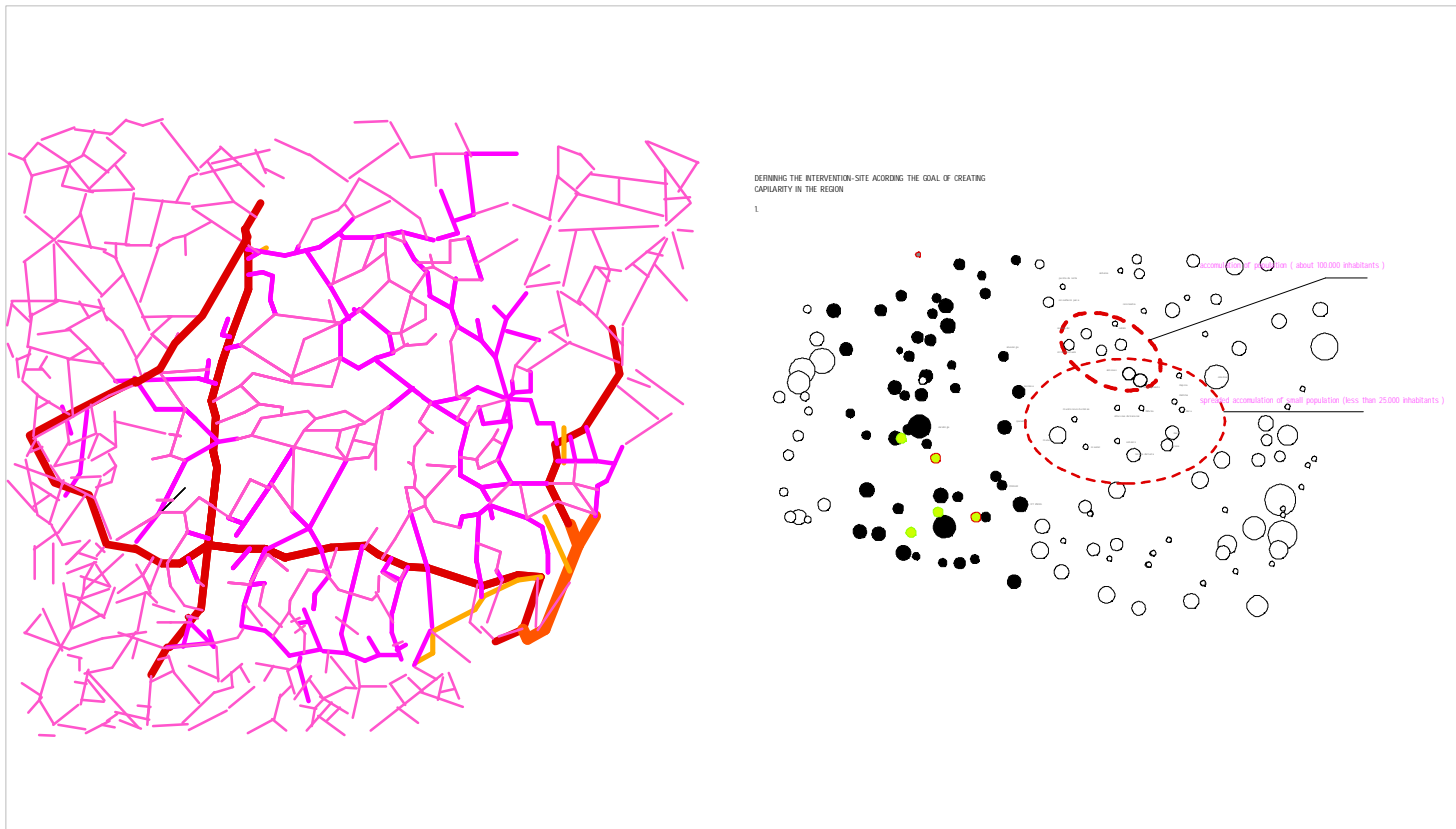

Linear city or Sprawl: trade, services of favorable properties - space for expansion, parking lots, delivery

creating subcorridors -clusters - redundant lines to existing network  
can happen in phases because of the economical...

site construction

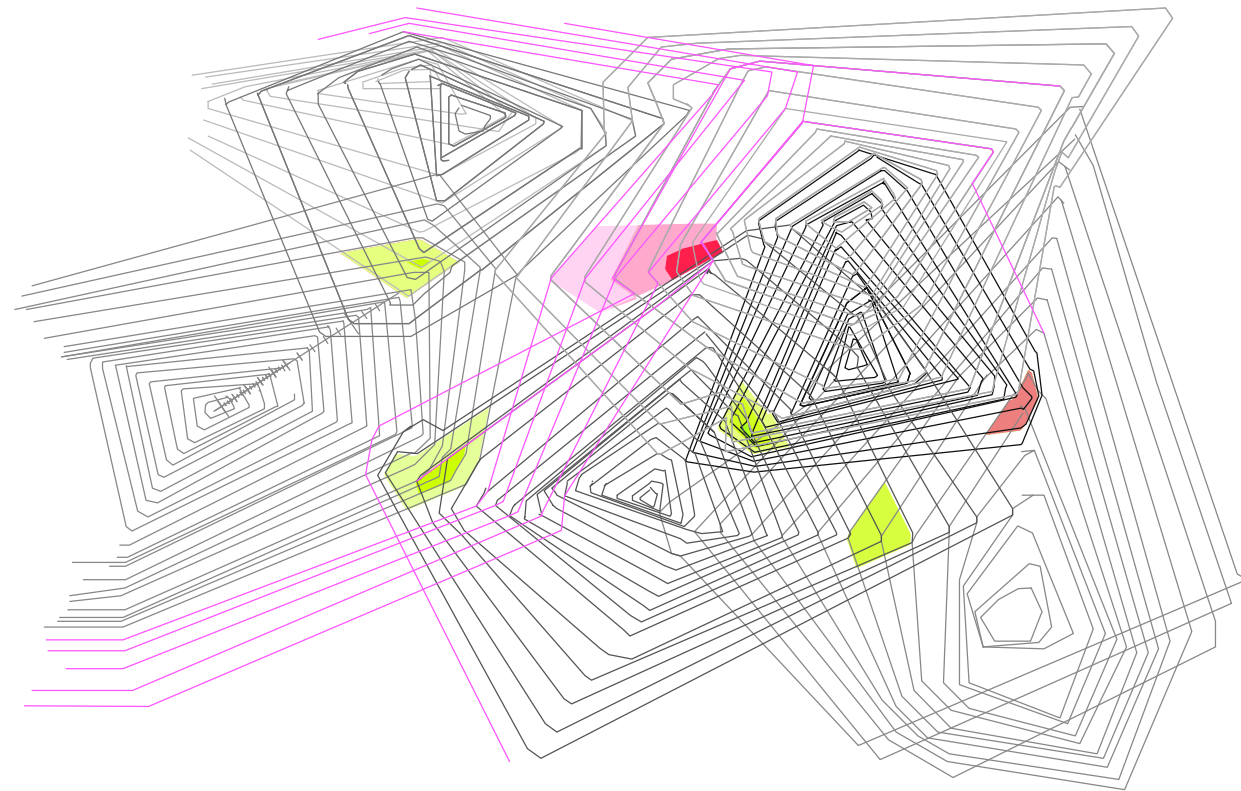

catalysing development through *implementation of a urban embryo*

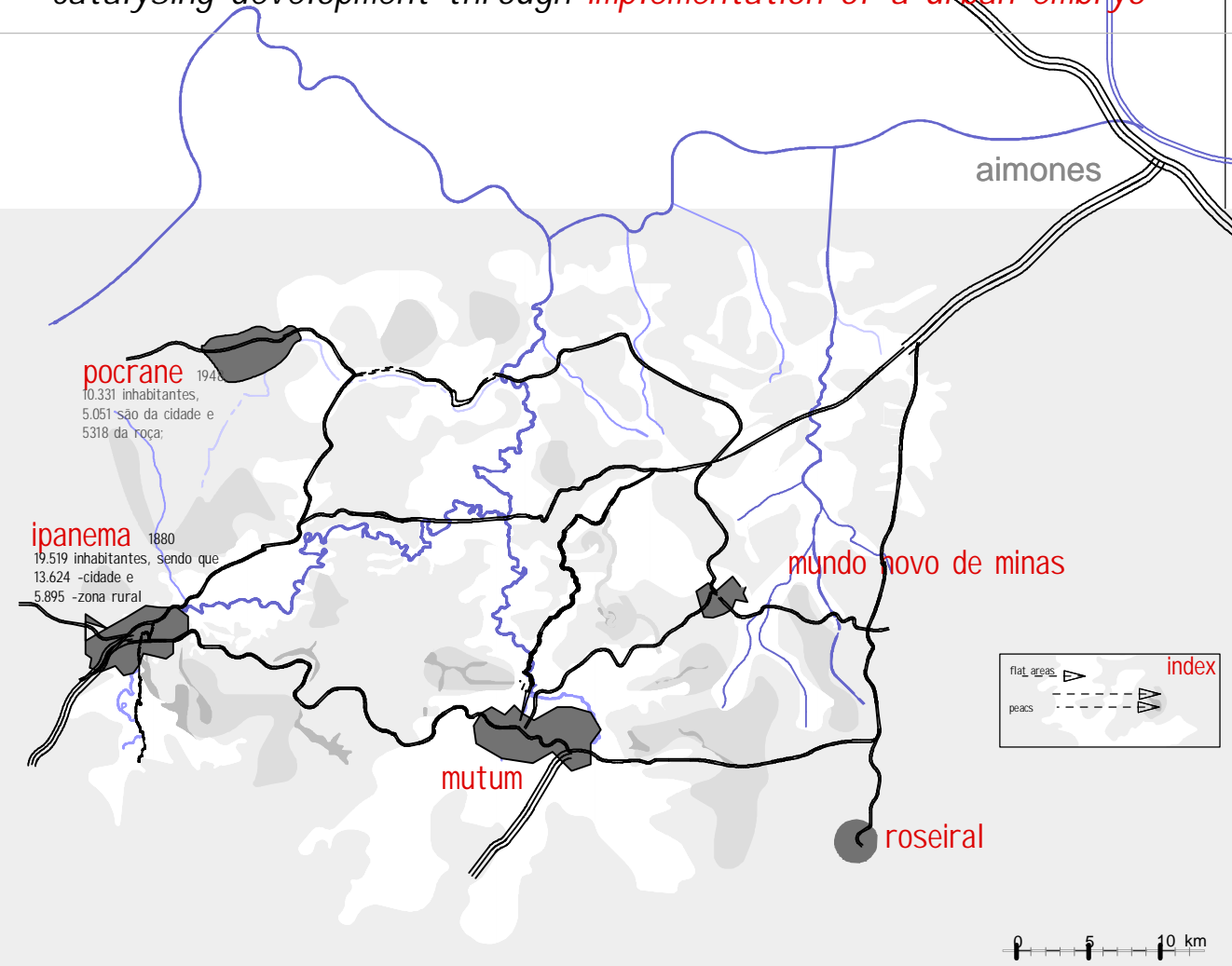

distances and connectivity points

infrastructural crossing points are good opportunity places to intervene, connecting minimum 3 sides ( connectivity 3) they can work as distributor and collector for a cluster of populations

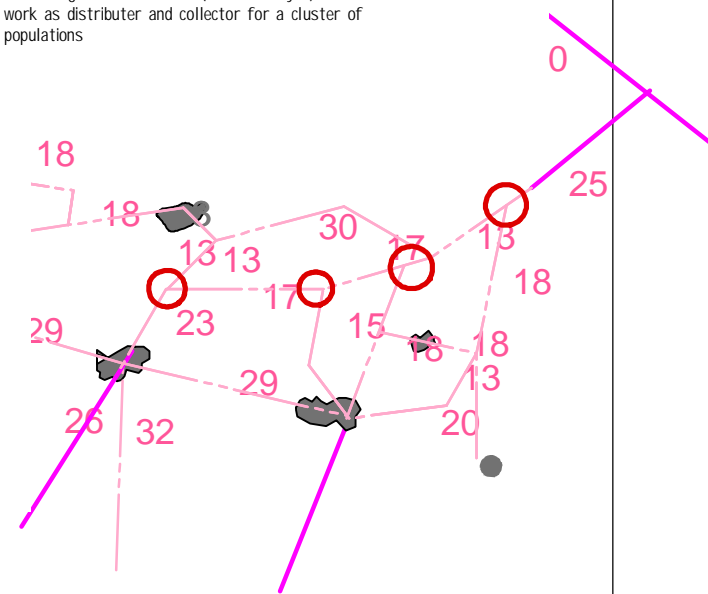

topographical conditions + infrastructure

map of the flat well accessed flat areas

in thinking of agricultural development as well as an expanding urban tissue this map give us information of possible intervening areas. the mountain side is natural border-conditions for growth. the areas where this border is nearly a parallel line to the infrastructure a linear growth across the line is possible, kind of linear city connecting existing urban settlements

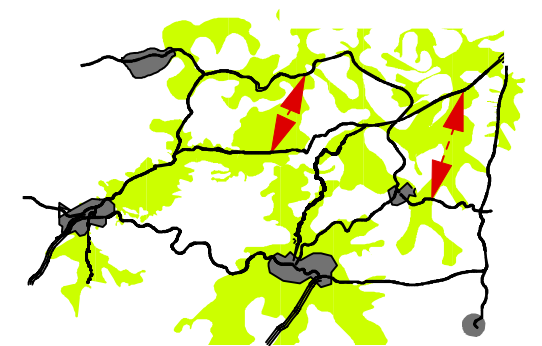

infrastructure meets river

in thinking of industrial aswell as argicultural activities a well accessed location with water access is important. this map show the crossing points of the cluster. the existing populations also have this condition.

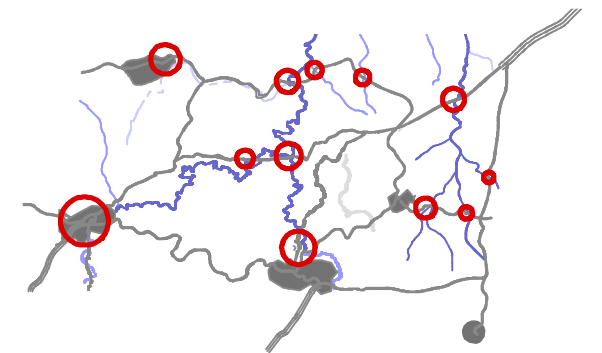

- X - closest between 2 populations/ or a-c = b-c
- X' -shortest destination between 2 shortest destination
- X'' - shortest destination between the pop - clusters
- A -closest connection between a-b with nodes - higher connectivity points
- A - overlapped with topographical information

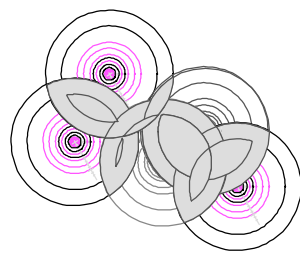

activating a region -

# WHAT PROJECTS CAN BE GENERATED TO BENEFIT THE INDUSTRY AND THE FAVELA?

## from the favela...

The favelas, to begin with, are irregular settlements of a very low social and economic level in which we find a great amount of unstable living units, condensed in a saturated way, built one on top of the other. Once the favelas have been analyzed several important points are deduced, from which a proposal can be generated:

- a) High density
- b) Total homogeneity
- c) Disconnection with the exterior

There are also valuable characteristics inside the favela which are important to conserve. These characteristics together with the mentioned above will lead to a better prototype for the favela:

- a) The trace appears in a natural and human way responding to a real situation of activity and movement in the favela.
- b) The morphology of the favela is autoregenerable, in other words, it doesn't respond to a determined disposition, and because of that the changes appear as an evolution and reaction inside itself.

## ...to the prototype.

this prototype means to be a container of activity different to the favela, which is inserted in the favela searching to generate diversity inside it. A flexible skeleton propagated throughout the favela, obeying traces and morphologies given by it, that at the same time extend themselves to reconfigure others.

Once inserted, this virus is consolidated as a reference point in terms of movement and activity because it reactivates the favela from strategical points, from which a chain reaction occurs reconfiguring it completely in an evolved way.

## what for and how?

This prototype is, as said above, a container of different activity; different compared to the favela. It reproduces itself inside the favela generating a network of activity containers that relate to each other as a reference and causing communication among themselves as they extend the emptinesses and paths to generate a great configuration of encounter points.

The existing paths inside the favela will extend themselves to encounter the viruses, and this at the same time will cause the favela to open up to the exterior and inside itself.

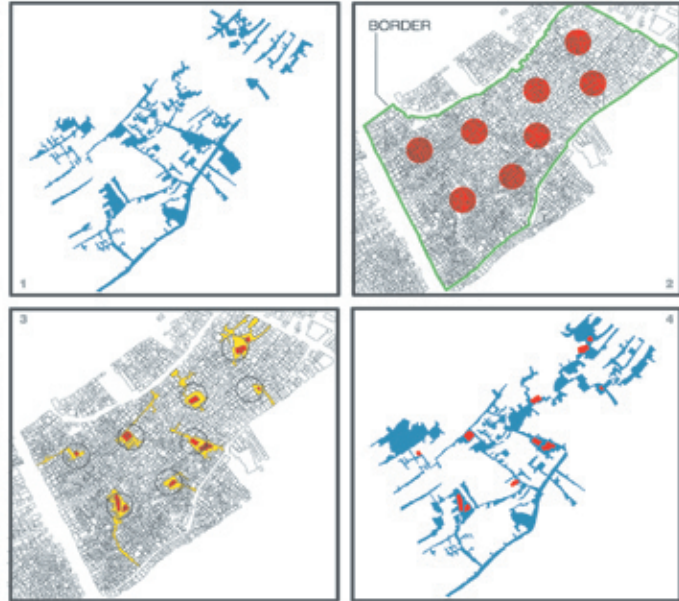

## DIFFERENCE STIMULATES

The intention is to create diversity in the favela by strategically inserting objects that contain activity.



ACTUAL SITUATIONS IN FAVELAS OF BRAZIL

**THE PROJECT TAKES THE CITY OF VITORIA, CAPITOL OF THE STATE OF ESPIRITU SANTO IN BRAZIL AS A MACRO LOCATION, INTERVENING IN THE FAVELA CALLED GURIGICA**



ESPIRITU SANTO



VITORIA



THE FAVELA



The intention of this project is to provide difference to the favela, contrary to the total homogeneity that rules it. The difference is obtained by the injection of four programs that benefit it social and economically. These programs are positioned strategically; seeking its auto propagation.

The programs are inserted in the favela sequentially in the order as listed:

**DETERMINED**

**SHOCK PROGRAM**



Light industry workshops; dispersed in the favela as icons, creating a network of connections that become reactivated by the circulation towards the workshops.

**SOCIAL PROGRAM**



Spaces for the use of social programs that benefit the favela in terms of activity and necessity. These spaces can be classrooms, libraries, sanitary centers, etc.

**FLUCTUANT PROGRAM**



Spaces of fluctuant use between the private intense and the public-collective, managed to be adapted to variable uses complementary to the favela and depending on the existing demand: commercial centers, restaurants, bars, etc.

**FIXED-FLUCTUANT PROGRAM**



This program is basically the relocation of the housing area that has been occupied or used by the shock and social programs.



Light industry workshops; dispersed in the favela as icons, creating a network of connections that become reactivated by the circulation towards the workshops.

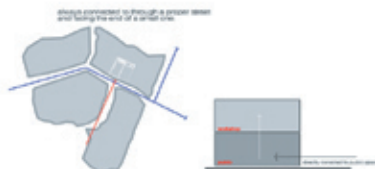
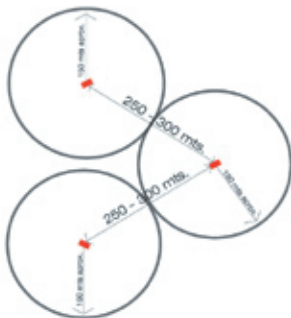
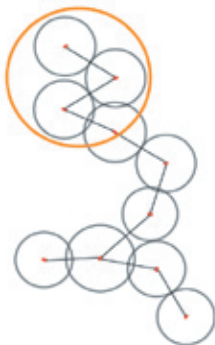

Spaces for the use of social programs that benefit the favela in terms of activity and necessity. These spaces can be classrooms, libraries, sanitary centers, etc.

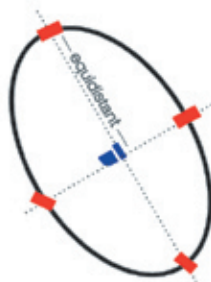

The designation of the area for the insertion of this program has to do with the disposition of the shock program. It appears in approximately the centre area between each of the light industries (shock programs).



Spaces of fluctuant use between the private intense and the public-collective, managed to be adapted to variable uses complementary to the favela and depending on the existing demand: commercial centers, restaurants, bars, cooperative centers.

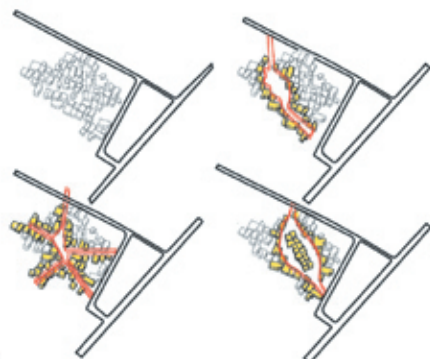

This program occupies the same grain of the favela. For the grain to become fluctuant it has to equip the favela with public space and relocate the living area it occupies. For this to happen the grain that is turned into fluctuant donates the same area to living space and half of the area to public space.



This program is basically the relocation of the housing area that was occupied or used by the shock and social programs

**DETERMINED**

The design for the housing buildings is based on the idea of providing each module with the same 'outside' area and raising the building to keep the ground floor available for a fluctuant or social program to appear. The public space in this case is common for two modules and has always the possibility of direct daylight and air.



**SELF ORGANIZED**

EXAMPLES OF CONFIGURATION 80x40x10



### THE TYPOLOGIES

Once the programs have been positioned in the favela and because of the proximity of some of them; a conformation of hybrid buildings occur, in other words, some of the programs are combined to create one building site in which the programs are mixed to act in conjunction.

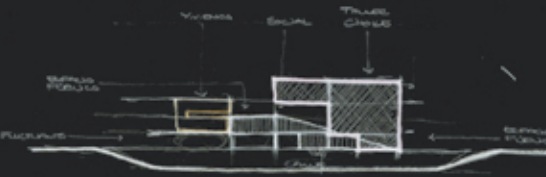

For this project there are basically two hybrid buildings:

- 1. Social program + fluctuant program + fixed-fluctuant

- 2. Shock program + social program + fluctuant program + fixed fluctuant



### SPECIFIC AREA OF INTERVENTION

Once the strategy is clear and the hybrid buildings defined schematically, the project is implemented in a specific area in the favela. For the application of the project only one of the typologies is developed.

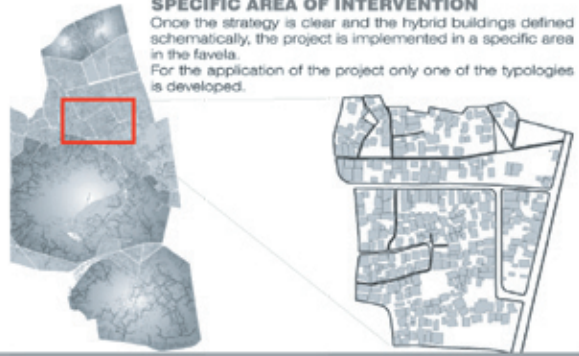

### THE HYBRID OBJECT/BUILDING

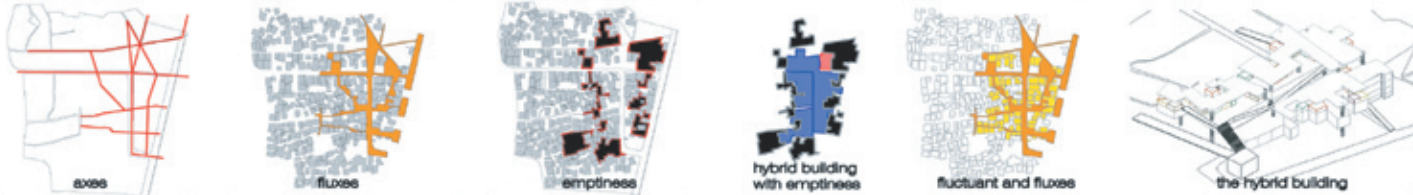

the hybrid building is composed by layers of concepts that lead the building to merge with the favela

### THE LAYERS



### THE BUILDING

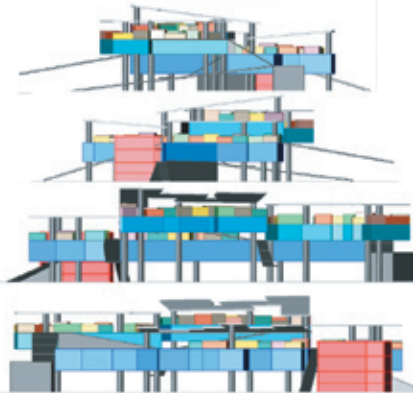

### MERGED WITH THE FAVELA

